

# Champ VMV HID luminaires

50-175W

Cl. I, Div. 2, Groups A, B, C, D  
Restricted Breathing Cl. I,  
Div. 2 & Zone 2 (with suffix  
S826)

Cl. II, Groups E, F, G  
Cl. III & Simultaneous  
Presence (HPS 50W, 70W)  
Marine & Wet Locations  
3, 3R, 4, 4X; IP56 to IP66

3L

## Applications:

Champ® VMV HID luminaires are used:

- In manufacturing plants, refineries, chemical, petrochemical and other industrial process facilities, waste or sewage treatment facilities, offshore, dockside and harbor installations, and other heavy industrial applications
- In areas in which ignitable concentrations of flammable gases or vapors will be present only due to abnormal, unusual or accidental conditions
- Where combustible dusts are present
- In marine applications where water spray and corrosive atmospheres are considerations
- In elevated ambient temperatures often found in industrial applications
- In installations where moisture, dirt, dust, vibration, corrosion and rough usage are problematic
- Wherever the damaging effects of water, wind, snow, sleet, hot sun or any combination of these elements are found

## Features:

- Compact, lightweight design is ideal for medium and low mounting heights
- Cast copper-free aluminum construction (less than 0.4 of 1% copper) and epoxy powder finish provide excellent resistance to corrosion
- Hinged ballast housing for ease of installation and maintenance
- Wide choice of photometric distributions; glass globes, refractors and compact refractors available for all wattage luminaires; plastic refractors (for non-hazardous applications only) for 50-100 watt luminaires
- All luminaires are designed to perform in a 40°C ambient temperature; selected luminaires are suitable for ambient temperatures up to 65°C
- Superior gasketing seals between the mounting module, housing and optical assembly for optimum performance in wet and corrosive environments
- Hubs with an integral conduit stop and bushing to help prevent damage to field wiring during installation
- Low ambient capability to -40°C
- Dome and 30° angle reflectors made of bright white Krydon material provide superior reflectivity, with twist-on feature requiring no tools or additional hardware; will not chip, peel, dent, rust or corrode
- Grounding wire for safety
- High power factor ballasts (min. P.F. 90%) and available in a variety of voltages to meet local area requirements
- Mogul base porcelain lamp socket



## Certifications and compliances:

### NEC/CEC:

- Class I, Division 2, Groups A, B, C, D
- Class I, Zone 2
- HPS 50W, 70W – Class II, Class III & Simultaneous Presence (Class I, Division 2 and Class II)

### UL standards:

- UL844 – Hazardous (Classified) Locations
- UL1598 – Luminaires
- UL1598A – Marine Locations

### CSA standard:

- C22.2 No. 137

### IEC standard:

- 60079-15

## Standard materials:

- Ballast housings and mountings – copper-free aluminum (less than 0.4 of 1%)
- Exterior hardware – stainless steel
- Reflectors (dome and angle) – Krydon fiberglass-reinforced polyester
- Globes – heat- and impact-resistant internally fluted glass
- Refractors – glass (50-175W); plastic (50-100W), for non-hazardous applications
- Guards – globe: copper-free aluminum; refractor: stainless steel

## Standard finishes:

- Copper-free aluminum – epoxy powder coat
- Krydon – high reflectance white
- Stainless steel – natural

## Electrical ratings:

- 120, 208, 240, 277, 347, 480, 600 volts and multi-tap (120, 208, 240 and 277 volts)
- 50-150W HPS; 70-175W MH

## Options:

- | Description  | Suffix        |
|--|---------------|
| • Factory sealed Champs.....   | <b>S865</b>   |
| <i>Class I, Division 2 &amp; Zone 2<br/>Provides T3 code without conduit or cable seals<br/>Restricted breathing/non-sparking</i>  |               |
| • Restricted breathing construction .....  | <b>S826</b>   |
| <i>Class I, Division 2 &amp; Zone 2 suitability<br/>Cooler operating temperatures (T-codes)</i>  |               |
| • Terminal block .....   | <b>S826TB</b> |
| <i>Furnished with terminal block, crimp terminals<br/>and dedicated voltage ballasts (no MT, DT or TT)</i>   |               |
| • Fused – to protect ballast and capacitors<br>against abnormal line conditions ....   | <b>S658A</b>  |
| <i>Not available with MT ballast<br/>Not for use in Canada<br/>Not suitable for marine applications</i>  |               |
| • Quick-Clip – holds weight of housing when<br>closed; no need to support luminaire while<br>screwing the housing to the cover....   | <b>S890</b>   |
| • Ballast-Gard™ starter cut-out switch –<br>prevents starter pulsing when lamp is<br>cycling or inoperative; prolongs ballast and<br>ignitor life.....   | <b>BG</b>     |
| <i>Available for use with 50-150W LX HPS only</i>  |               |
| • Instant restrike – enables a hot HPS lamp<br>to immediately restrike after a momentary<br>loss arc due to voltage fluctuation or<br>power outage; has no effect on the warm-<br>up period of cold lamps..... | <b>IR</b>     |
| <i>50-150W LX HPS only</i>   |               |
| • During a “failed lamp” condition, this<br>feature discontinues the start-up operation<br>after 1 minute.....   | <b>TIR</b>    |
| <i>50-150W LX HPS only</i>   |               |
| • Quartz auxiliary lighting – comes to full<br>brightness immediately and remains lit<br>until the HID lamp attains 60-70% of full<br>illumination.....  | <b>QTZ</b>    |
| <i>For non-hazardous locations only<br/>Must use R2, R3 or R5 refractors</i>   |               |
| • Refractor mount .....  | <b>RM</b>     |
| <i>For ballast housing only<br/>Used with R2, R3 and R5 refractors</i>   |               |
| • Stainless steel insert – top hat with<br>stainless steel threaded insert to attach<br>ballast housing.....   | <b>S806</b>   |
| • Teflon coating on globe for increased<br>shatter protection .....  | <b>S808</b>   |
| <i>Available on G24 only<br/>T-codes not affected</i>  |               |
| • Factory assembled with HID lamps<br>installed for additional labor savings.....  | <b>FA</b>     |

**Note:** BG and IR options cannot be used together. IR and QTZ options cannot be used together. S865 and S826 options cannot be used together.

## Photometrics:

- Refer to [www.eaton.com](http://www.eaton.com) (under the Resources tab of each product family) for specific photometric IES files

**A** When ordering fuses for luminaires, you must specify the operating voltage. S658 cannot be ordered with /MT in the catalog number.

# Champ VMV HID luminaires

50-150W high pressure sodium

Cl. I, Div. 2, Groups A, B, C, D  
Restricted Breathing Cl. I,  
Div. 2 & Zone 2 (with suffix  
S826)

Cl. II, Groups E, F, G, Cl. III  
& Simultaneous Presence  
(HPS 50W, 70W)  
Marine & Wet Locations  
3, 3R, 4, 4X; IP66

3L

To complete the catalog number, include information in Notes 1, 2 and 3 below. For guards and other optics, see VMV – ordering by components page.

### BASIC CATALOG NUMBER



Mounting style	Hub size	Lamp watts	Cat. # With G24 globe and P21 guard	Cat. # With G241 Type I compact refractor <sup>ⓑ</sup>	Cat. # With R5 glass refractor <sup>Ⓒ</sup>
Pendant mount	3/4"	50	VMVS2A050GP	VMVS2A050G241	VMVS2A050R5
		70	VMVS3A050GP	VMVS3A050G241	VMVS3A050R5
	1"	70	VMVS2A070GP	VMVS2A070G241	VMVS2A070R5
		100	VMVS3A070GP	VMVS3A070G241	VMVS3A070R5
	3/4"	100	VMVS2A100GP	VMVS2A100G241	VMVS2A100R5
		150	VMVS3A100GP	VMVS3A100G241	VMVS3A100R5
1"	150	VMVS2A150GP	VMVS2A150G241	VMVS2A150R5	
	150	VMVS3A150GP	VMVS3A150G241	VMVS3A150R5	



Flexible pendant mount	3/4"	50	VMVS2HA050GP	VMVS2HA050G241	VMVS2HA050R5
		70	VMVS2HA070GP	VMVS2HA070G241	VMVS2HA070R5
	1"	100	VMVS2HA100GP	VMVS2HA100G241	VMVS2HA100R5
		150	VMVS2HA150GP	VMVS2HA150G241	VMVS2HA150R5



Ceiling mount through feed	3/4"	50	VMVS2C050GP	VMVS2C050G241	VMVS2C050R5
		70	VMVS3C050GP	VMVS3C050G241	VMVS3C050R5
	1"	70	VMVS2C070GP	VMVS2C070G241	VMVS2C070R5
		100	VMVS3C070GP	VMVS3C070G241	VMVS3C070R5
	3/4"	100	VMVS2C100GP	VMVS2C100G241	VMVS2C100R5
		150	VMVS3C100GP	VMVS3C100G241	VMVS3C100R5
1"	150	VMVS2C150GP	VMVS2C150G241	VMVS2C150R5	
	150	VMVS3C150GP	VMVS3C150G241	VMVS3C150R5	



Wall mount through feed	3/4"	50	VMVS2TW050GP	VMVS2TW050G241	VMVS2TW050R5
		70	VMVS3TW050GP	VMVS3TW050G241	VMVS3TW050R5
	1"	70	VMVS2TW070GP	VMVS2TW070G241	VMVS2TW070R5
		100	VMVS3TW070GP	VMVS3TW070G241	VMVS3TW070R5
	3/4"	100	VMVS2TW100GP	VMVS2TW100G241	VMVS2TW100R5
		150	VMVS3TW100GP	VMVS3TW100G241	VMVS3TW100R5
1"	150	VMVS2TW150GP	VMVS2TW150G241	VMVS2TW150R5	
	150	VMVS3TW150GP	VMVS3TW150G241	VMVS3TW150R5	



Quad mount Pendant, adjustable through feed, 25° angle, 12 1/2° angle	3/4"	50	VMVS25Q050GP	VMVS25Q050G241	VMVS25Q050R5
	3/4"	70	VMVS25Q070GP	VMVS25Q070G241	VMVS25Q070R5
	1"	100	VMVS25Q100GP	VMVS25Q100G241	VMVS25Q100R5
	1"	150	VMVS25Q150GP	VMVS25Q150G241	VMVS25Q150R5



Stanchion mount 25° angle	1 1/2"	50	VMVSJ050GP	VMVSJ050G241	VMVSJ050R5
	1 1/2"	70	VMVSJ070GP	VMVSJ070G241	VMVSJ070R5
	1 1/2"	100	VMVSJ100GP	VMVSJ100G241	VMVSJ100R5
	1 1/2"	150	VMVSJ150GP	VMVSJ150G241	VMVSJ150R5



Stanchion mount Straight	1 1/2"	50	VMVSP050GP	VMVSP050G241	VMVSP050R5
	1 1/2"	70	VMVSP070GP	VMVSP070G241	VMVSP070R5
	1 1/2"	100	VMVSP100GP	VMVSP100G241	VMVSP100R5
	1 1/2"	150	VMVSP150GP	VMVSP150G241	VMVSP150R5

<sup>ⓑ</sup> For G243 Type III compact refractor, change '241' at end of catalog number to '243.' Example: VMVS2A050G243.  
For G245 Type V compact refractor, change '241' at end of catalog number to '245.' Example: VMVS2A050G245.

<sup>Ⓒ</sup> For R2 glass refractor, change 'R5' at end of catalog number to 'R2.' Example: VMVS2A050R2.  
For R3 glass refractor, change 'R5' at end of catalog number to 'R3.' Example: VMVS2A050R3.

#### 1. Add voltage suffix to end of catalog number (example: VMVS2C070GP/480).

Standard voltage ballasts – 60 Hz

NEC/UL		CEC/CSA (cUL)		
<b>Voltage</b>	Multi-tap	Dual-tap	120V	480V
<b>Suffix</b>	/MT	/DT	/120	/480
			Tri-tap	Dual-tap
			/TT	/DT
				/120

Multi-tap and dual-tap ballasts are powered for 277V.

Optional voltage ballasts – 50 or 60 Hz

CEC/CSA (cUL) – CWI isolated ballasts				Export			
<b>Voltage</b>	208V CWI	240V CWI	480V CWI	600V CWI	220V 60 Hz	220V 50 Hz	240V 50 Hz
<b>Suffix</b>	/208 CWI	/240 CWI	/480 CWI	/600 CWI	/220	/220 50	/240 50

#### 2. 150W HPS luminaires:

- 55V lamps standard – use suffix LX; for 100V lamps – use suffix CE
- 50W HPS luminaire is dual-tap only

#### 3. Options: Add the required option suffixes in alphanumeric order.

# Champ VMV HID luminaires

150-175W pulse start metal halide







Cl. I, Div. 2, Groups A, B, C, D  
Restricted Breathing Cl. I,  
Div. 2 & Zone 2 (with suffix  
S826)

Marine & Wet Locations  
3, 3R, 4, 4X; IP66

3L

To complete the catalog number, include information in Note 1 below. For guards and other optics, see VMV – ordering by components page.

### BASIC CATALOG NUMBER

Mounting style	Hub size	Lamp watts	Cat. #		
			With G24 globe and P21 guard	With G245 Type V compact refractor <sup>Ⓓ</sup>	With R5 glass refractor <sup>Ⓔ</sup>
	3/4"	150	VMVM2A150GP S828	VMVM2A150G245 S828	VMVM2A150R5 S828
			VMVM3A150GP S828	VMVM3A150G245 S828	VMVM3A150R5 S828
	1"	175	VMVM2A175GP S828	VMVM2A175G245 S828	VMVM2A175R5 S828
			VMVM3A175GP S828	VMVM3A175G245 S828	VMVM3A175R5 S828
	3/4"	150	VMVM2HA150GP S828	VMVM2HA150G245 S828	VMVM2HA150R5 S828
	3/4"	175	VMVM2HA175GP S828	VMVM2HA175G245 S828	VMVM2HA175R5 S828
	3/4"	150	VMVM2C150GP S828	VMVM2C150G245 S828	VMVM2C150R5 S828
			VMVM3C150GP S828	VMVM3C150G245 S828	VMVM3C150R5 S828
	1"	175	VMVM2C175GP S828	VMVM2C175G245 S828	VMVM2C175R5 S828
			VMVM3C175GP S828	VMVM3C175G245 S828	VMVM3C175R5 S828
	3/4"	150	VMVM2TW150GP S828	VMVM2TW150G245 S828	VMVM2TW150R5 S828
			VMVM3TW150GP S828	VMVM3TW150G245 S828	VMVM3TW150R5 S828
	1"	175	VMVM2TW175GP S828	VMVM2TW175G245 S828	VMVM2TW175R5 S828
			VMVM3TW175GP S828	VMVM3TW175G245 S828	VMVM3TW175R5 S828
	3/4"	150	VMVM25Q150GP S828	VMVM25Q150G245 S828	VMVM25Q150R5 S828
	3/4"	175	VMVM25Q175GP S828	VMVM25Q175G245 S828	VMVM25Q175R5 S828
	1 1/2"	150	VMVMJ150GP S828	VMVMJ150G245 S828	VMVMJ150R5 S828
	1 1/2"	175	VMVMJ175GP S828	VMVMJ175G245 S828	VMVMJ175R5 S828
	1 1/2"	150	VMVMP150GP S828	VMVMP150G245 S828	VMVMP150R5 S828
	1 1/2"	175	VMVMP175GP S828	VMVMP175G245 S828	VMVMP175R5 S828

<sup>Ⓓ</sup>For G241 Type I compact refractor, change '245' at end of catalog number to '241'. Example: VMVM2A150G241 S828.  
For G243 Type III compact refractor, change '245' at end of catalog number to '243'. Example: VMVM2A150G243 S828.

<sup>Ⓔ</sup>For R2 glass refractor, change 'R5' at end of catalog number to 'R2'. Example: VMVM2A150R2 S828.  
For R3 glass refractor, change 'R5' at end of catalog number to 'R3'. Example: VMVM2A150R3 S828.

#### 1. Add voltage suffix to end of catalog number (example: VMVM2A175GP/MT S828).

Standard voltage ballasts – 60 Hz

NEC/UL			CEC/CSA (cUL)		
<b>Voltage</b>	Multi-tap	120V	480V	Tri-tap	120V
<b>Suffix</b>	/MT	/120	/480	/TT	/120

Optional voltage ballasts – 50 or 60 Hz

Export				
<b>Voltage</b>	220V 60 Hz	220V 50 Hz	230V 50 Hz	240V 50 Hz
<b>Suffix</b>	/220	/220 50	/230 50	/240 50

# Champ VMV HID luminaires

70-175W metal halide

Cl. I, Div. 2, Groups A, B, C, D  
Restricted Breathing Cl. I,  
Div. 2 & Zone 2 (with suffix  
S826)

Marine & Wet Locations  
3, 3R, 4, 4X; IP66

3L

To complete the catalog number, include information in Notes 1, 2 and 3 below. For guards and other optics, see VMV – ordering by components page.

### BASIC CATALOG NUMBER



Mounting style	Hub size	Lamp watts	Cat. # With G24 globe and P21 guard	Cat. # With G241 Type I compact refractor <sup>Ⓕ</sup>	Cat. # With R5 glass refractor <sup>Ⓖ</sup>
Pendant mount	3/4"	70	VMVM2A070GP	VMVM2A070G241	VMVM2A070R5
			VMVM3A070GP	VMVM3A070G241	VMVM3A070R5
	1"	100	VMVM2A100GP	VMVM2A100G241	VMVM2A100R5
			VMVM3A100GP	VMVM3A100G241	VMVM3A100R5
	3/4"	175	VMVM2A175GP	VMVM2A175G241	VMVM2A175R5
			VMVM3A175GP	VMVM3A175G241	VMVM3A175R5



Flexible pendant mount	3/4"	70	VMVM2HA070GP	VMVM2HA070G241	VMVM2HA070R5
	3/4"	100	VMVM2HA100GP	VMVM2HA100G241	VMVM2HA100R5
	3/4"	175	VMVM2HA175GP	VMVM2HA175G241	VMVM2HA175R5



Ceiling mount through feed	3/4"	70	VMVM2C070GP	VMVM2C070G241	VMVM2C070R5
			VMVM3C070GP	VMVM3C070G241	VMVM3C070R5
	1"	100	VMVM2C100GP	VMVM2C100G241	VMVM2C100R5
			VMVM3C100GP	VMVM3C100G241	VMVM3C100R5
	3/4"	175	VMVM2C175GP	VMVM2C175G241	VMVM2C175R5
			VMVM3C175GP	VMVM3C175G241	VMVM3C175R5



Wall mount through feed	3/4"	70	VMVM2TW070GP	VMVM2TW070G241	VMVM2TW070R5
			VMVM3TW070GP	VMVM3TW070G241	VMVM3TW070R5
	1"	100	VMVM2TW100GP	VMVM2TW100G241	VMVM2TW100R5
			VMVM3TW100GP	VMVM3TW100G241	VMVM3TW100R5
	3/4"	175	VMVM2TW175GP	VMVM2TW175G241	VMVM2TW175R5
			VMVM3TW175GP	VMVM3TW175G241	VMVM3TW175R5



Quad mount Pendant, adjustable through feed, 25° angle, 12 1/2° angle	3/4"	70	VMVM25Q070GP	VMVM25Q070G241	VMVM25Q070R5
	3/4"	100	VMVM25Q100GP	VMVM25Q100G241	VMVM25Q100R5
	3/4"	175	VMVM25Q175GP	VMVM25Q175G241	VMVM25Q175R5



Stanchion mount 25° angle	1 1/2"	70	VMVMJ070GP	VMVMJ070G241	VMVMJ070R5
	1 1/2"	100	VMVMJ100GP	VMVMJ100G241	VMVMJ100R5
	1 1/2"	175	VMVMJ175GP	VMVMJ175G241	VMVMJ175R5



Stanchion mount Straight	1 1/2"	70	VMVMMP070GP	VMVMMP070G241	VMVMMP070R5
	1 1/2"	100	VMVMMP100GP	VMVMMP100G241	VMVMMP100R5
	1 1/2"	175	VMVMMP175GP	VMVMMP175G241	VMVMMP175R5

Ⓕ For G243 Type III compact refractor, change '241' at end of catalog number to '243.' Example: VMVM2A070G243.

For G245 Type V compact refractor, change '241' at end of catalog number to '245.' Example: VMVM2A070G245.

Ⓖ For R2 glass refractor, change 'R5' at end of catalog number to 'R2.' Example: VMVM2A070R2.

For R3 glass refractor, change 'R5' at end of catalog number to 'R3.' Example: VMVM2A070R3.

### 1. Add voltage suffix to end of catalog number (example: VMVM2A070G241/120).

Standard voltage ballasts – 60 Hz

NEC/UL		CEC/CSA (cUL)	
<b>Voltage</b>	Multi-tap	120V	480V
<b>Suffix</b>	/MT	/120	/480

Optional voltage ballasts – 50 or 60 Hz

CEC/CSA (cUL) – CWI isolated ballasts			Export				
<b>Voltage</b>	208V CWI	480V CWI	600V CWI	220V 60 Hz	220V 50 Hz	230V 50 Hz	240V 50 Hz
<b>Suffix</b>	/208 CWI	/480 CWI	/600 CWI	/220	/220 50	/230 50	/240 50

### 2. 70W ballast not available in 480V.

### 3. Options: Add the required option suffixes in alphanumeric order.

# Champ VMV HID luminaires

Ordering by components

Cl. I, Div. 2, Groups A, B, C, D  
Restricted Breathing Cl. I,  
Div. 2 & Zone 2 (with suffix  
S826)

Cl. II, Groups E, F, G  
Cl. III & Simultaneous  
Presence (HPS 50W, 70W)  
Marine & Wet Locations  
3, 3R, 4, 4X; IP56 to IP66

3L

**VMV luminaires are available in components.**

A complete luminaire consists of:

- I. Champ cover (mounting module)
- II. VMV ballast housing – include voltage and required option(s)
- III. Globe, guard, reflector, refractor

## I. Champ cover (mounting module):

Type	Conduit size	Cat. #
Pendant mount	$\frac{3}{4}$ " 1"	APM2 APM3
Flexible pendant mount	$\frac{3}{4}$ "	HPM2
Ceiling mount <sup>Ⓜ</sup>	$\frac{3}{4}$ " 1"	CM2 CM3
Wall mount	$\frac{3}{4}$ " 1"	TWM2 TWM3
Stanchion mount – 25° angle	1½"	JM5
Stanchion mount – straight	1½"	PM5
Quad mount	$\frac{3}{4}$ "	QM25

## II. Ballast housings:

Complete catalog number must have the **voltage suffix** and any **options suffixes**.

Lamp type	Lamp watts	Cat. # Globe and compact refractor	Cat. # Large refractor
High pressure sodium	50	VMVS050/DT	VMVS050/DT RM
	70	VMVS070/MT	VMVS070/MT RM
	100	VMVS100/MT	VMVS100/MT RM
	150	VMVS150/MT LX	VMVS150/MT LX RM
Metal halide	70	VMVM070/MT	VMVM070/MT RM
	100	VMVM100/MT	VMVM100/MT RM
	175	VMVM175/MT	VMVM175/MT RM

## III. Globes, guards, reflectors, refractors:

Type	Cat. #
Globe	G24
Globe – Teflon coated	G24 S808
Globe guard	P21
Reflector – dome	RD70
Reflector – angle	RA70
Compact refractor – Type I	G241
Compact refractor – Type III	G243
Compact refractor – Type V	G245
Compact refractor guard	P241
Large refractor – Type II	R2
Large refractor – Type III	R3
Large refractor – Type V	R5
Large refractor guard	P23
Large plastic refractor – Type II	PR2
Large plastic refractor – Type III	PR3
Large plastic refractor – Type V	PR5

<sup>Ⓜ</sup>Not available with V2PC photocell.

# Champ VMV HID luminaires

Cl. I, Div. 2, Groups A, B, C, D  
Restricted Breathing Cl. I,  
Div. 2 & Zone 2 (with suffix  
S826)

Cl. II, Groups E, F, G  
Cl. III & Simultaneous  
Presence (HPS 50W, 70W)  
Marine & Wet Locations  
3, 3R, 4, 4X; IP56 to IP66

3L

## Family tree:

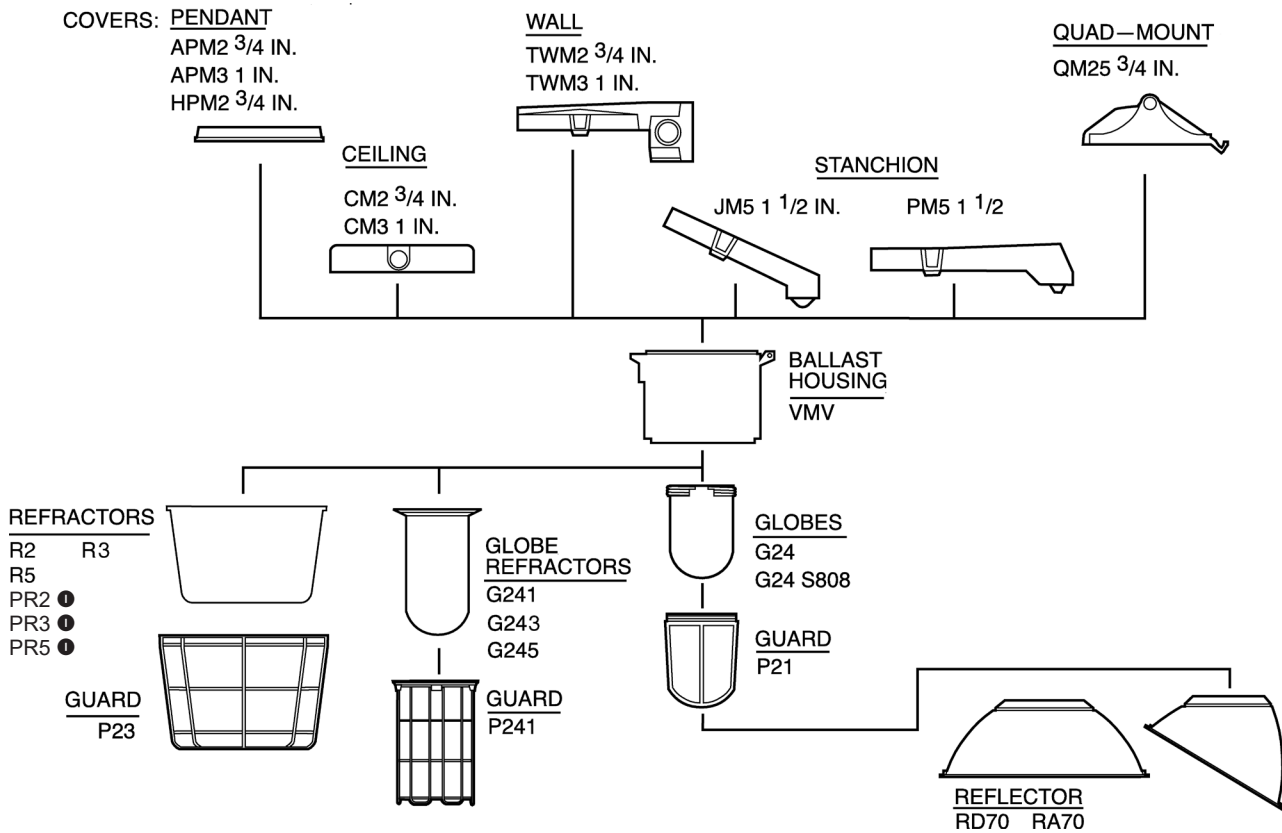

Plastic refractors are for non-hazardous areas only (50-100W max.)



# Champ VMV HID luminaires

Cl. I, Div. 2, Groups A, B, C, D  
Restricted Breathing Cl. I,  
Div. 2 & Zone 2 (with suffix  
S826)

Cl. II, Groups E, F, G  
Cl. III & Simultaneous  
Presence (HPS 50W, 70W)  
Marine & Wet Locations  
3, 3R, 4, 4X; IP56 to IP66

3L

## Temperature performance data:

Cat. #	Lamp		Rated ambient °C	Class I, Div. 2			Group	Class II, Div. 1		Class I, Zone 2		Supply wire suitable for °C	
	Watts	Type		Globe (G24, G241, G245)	Globe (G24) with reflector (RA70, RD70)	Reflector (R2, R3, R5)		Globe (G24) with or without reflector (RA70, RD70)	Simult. Pres. Class I, Div. 2; Class II, Div. 1	Restricted breathing suffix S826 with globe (G24, G241, G245)	Factory sealed suffix S865 AEx nA nR II	Globe (G24, G241, G245)	Reflector (R2, R3, R5)
VMVM70	70	MH	40	T3A	T3A	T3A	–	T3A	–	T5	T3	90	90
VMVM70	70	MH	55	T3	T3	T3	–	T3	–	T4	T3	90	90
VMVM70	70	MH	65	T3	T3	T3	–	T3	–	T4	T3	90	90
VMVM100	100	MH	40	T2D	T2D	T2D	–	T2D	–	T4	T3	90	90
VMVM100 S849	100	MH	40	T2	T2	T2	–	T2	–	T4	T3	75	75
VMVM100	100	MH	55	T2D	T2D	T2D	–	T2D	–	T4	T3	90	90
VMVM150	150	MH	40	T2A	T2A	T2B	–	T2A	–	T3	T3	90	90
VMVM175	175	MH	40	T2A	T2A	T2B	–	T2A	–	T3	T3	90	90
VMVS50	50	HPS	40	T3A	T3A	T3B	EFG	T4A	T3A	T5	T3	75	65
VMVS50	50	HPS	55	T3A	T3A	T3A	EFG	T4	T3	T5	T3	75	75
VMVS50	50	HPS	65	T3	T3	T3	EFG	T4	T2D	T5	T3	75	75
VMVS70	70	HPS	40	T3	T3	T3B	EFG	T3C	T2C	T4	T3	75	65
VMVS70	70	HPS	55	T3	T3	T3	EFG	T3C	T2B	T4	T3	90	90
VMVS100	100	HPS	40	T2C	T2C	T2D	EFG	T3A	T2A	T4	T3	90	75
VMVS100	100	HPS	55	T2B	T2B	T2C	EFG	–	–	T3	T3	105	90
VMVS150	150	HPS	40	T2A	T2A	T2B	–	–	–	T3	T3	90	85
VMVS150	150	HPS	55	T2	T2	T2A	–	–	–	T3	T3	105	105

The Class I, Division 2 T-codes apply to luminaires without the restricted breathing (S826) or factory sealed (S865) options. These luminaires are listed to UL844. UL844 specifies how the temperatures are measured.

The Class I, Zone 2 T-codes are for luminaires that are additionally listed to UL60079-15 that specify a different method for measuring temperatures. Since NEC 501.1 states that equipment "...for use in Class I, Zone 0, 1 or 2 locations shall be permitted in Class I, Division 2 locations..." then these luminaires are suitable for Class I, Division 2 but with cooler temperature ratings. They also have the advantage of meeting the more rigorous mechanical tests of UL844.

# Champ VMV HID luminaires

Cl. I, Div. 2, Groups A, B, C, D  
Restricted Breathing Cl. I,  
Div. 2 & Zone 2 (with suffix  
S826)

Cl. II, Groups E, F, G  
Cl. III & Simultaneous  
Presence (HPS 50W, 70W)  
Marine & Wet Locations  
3, 3R, 4, 4X; IP56 to IP66

3L

## Dimensions (in inches):

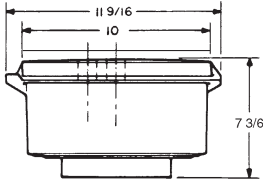

Pendant mount

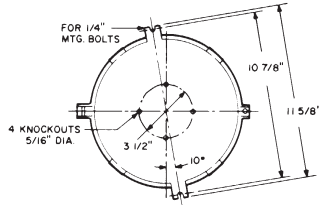

Ceiling mount top view

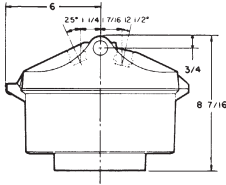

Quad mount

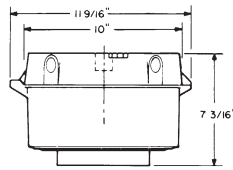

Ceiling mount (5 hubs, 4 plugged)

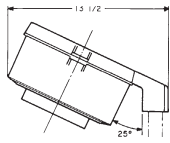

Stanchion mount 25° angle

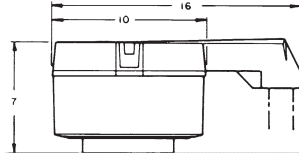

Stanchion mount straight

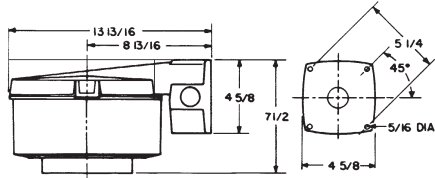

Wall mount (5 hubs, 4 plugged)

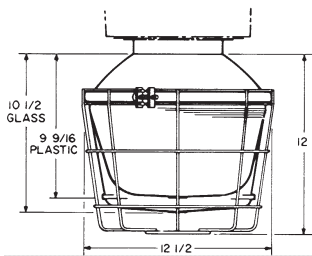

Luminaire with refractors,  
guard

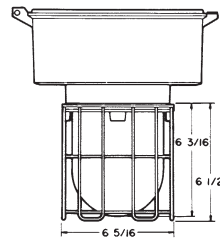

Compact refractor

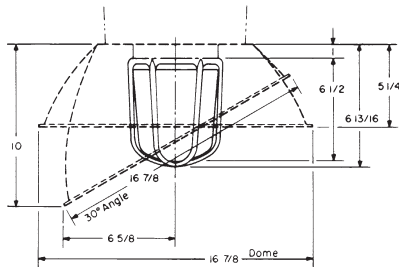

Globe, guard, reflectors

## Net luminaire weights:

Luminaire series	Lamp watts				
	50	70	100	150	175
<b>Luminaire with globe, guard (lbs.):</b>					
VMVS	13.50	14.50	14.50	14.50	
VMVM		13.00	13.25		15.50
<b>Luminaire with glass refractor (lbs.):</b>					
VMVS	21.75	22.75	22.75	22.75	
VMVM		21.00	21.50		23.75

Type	Weight (lbs.)	Type	Weight (lbs.)
<b>Add mounting modules:</b>			
Pendant	1.25	Quad	3.50
Flexible pendant	1.50	Stanchion 25° angle	3.50
Ceiling	2.75	Stanchion straight	4.50
Wall	4.50		
<b>Add reflectors:</b>			
Dome	1.50	30° angle	1.50

**Deduct:** 0.50 lbs. for fixture without P21 guard

3L